



INSTALLATION INSTRUCTIONS

Accessory	Application	Publication No.
GRIP HEATER P/N 08T71-MKT-D00	ADV750	MII
		Issue Date
		December 2020

Accessory	Application	Publication No.
GRIP HEATER P/N 08T71-MKT-D00	ADV750	MII
		Issue Date
		December 2020

Accessory	Application	Publication No.
GRIP HEATER P/N 08T71-MKT-D00	ADV750	MII
		Issue Date
		December 2020

Honda Dealer: Please give a copy of these instructions to your customer.

PARTS LIST

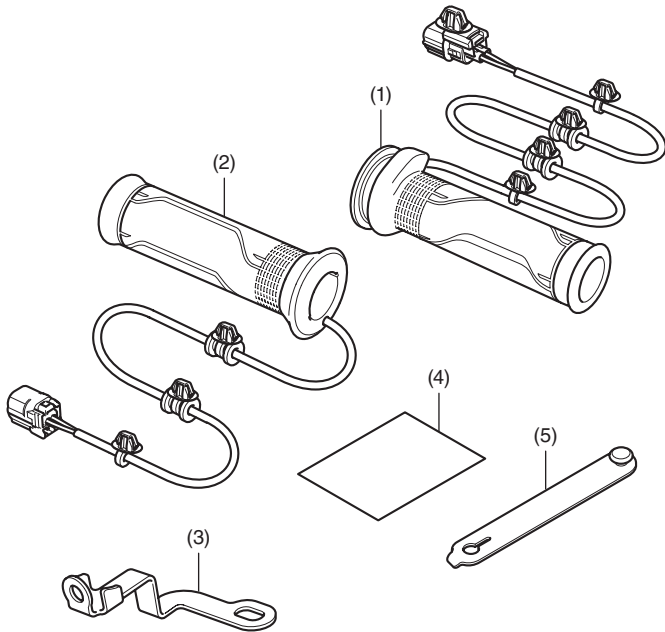

No.	Description	Qty
(1)	Right grip heater unit	1
(2)	Left grip heater	1
(3)	Clamp	1
(4)	URL paper	1
(5)	Rubber band	1

TOOLS AND SUPPLIES REQUIRED

- Flat-tip screwdriver
- Honda Bond A
- Thread lock
- Scale
- Grease
- Isopropyl alcohol
- Shop towel
- Torque wrench

TORQUE CHART

Refer to the Service Manual for the torque values of the removed parts.

INSTALLATION

▲ CAUTION

- To prevent burns, allow the engine, exhaust system, radiator, etc., to cool before installing the accessory.

NOTE:

- Remove the right grip as instructed in the motorcycle's Service Manual.
- For secure adhesion of the grip heaters use the recommended adhesive agent (Honda Bond A) or equivalent.
- Be sure to open and close the throttle to check for smooth operation after installation of the right grip heater.
- Disconnect the negative (-) cable from the battery before installing this accessory.
- The memories of the clock will be erased when you disconnect the battery. Reset the memories after reconnecting the battery.
- Reinstall the removed parts on the motorcycle and make sure that the wires and harnesses are not pinched.
- After handle grip heater installation, check the lights (e.g. right / left turn signal lights and brake lights) for proper operation.
- Setting is necessary after installing this accessory.

1. Open the seat.
2. Remove the maintenance lid as shown, and disconnect the negative (-) cable of the battery.

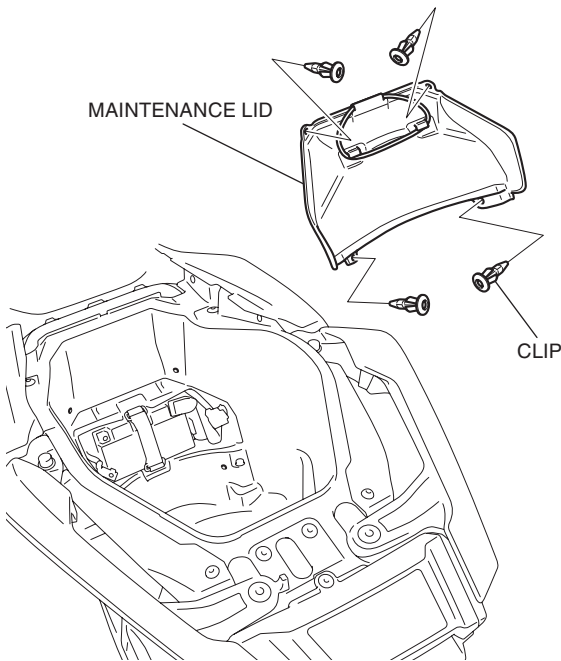

3. Remove the left rear cowl as shown.
<Left side>

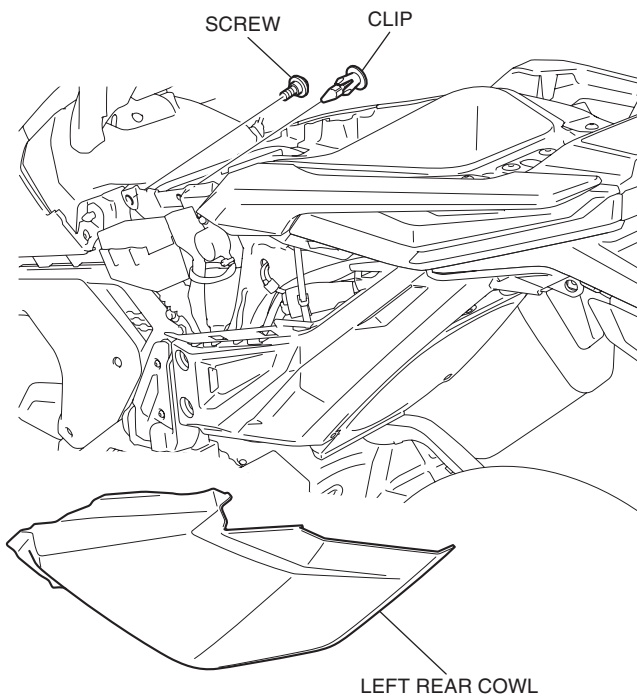

4. Remove the inner cover as shown.

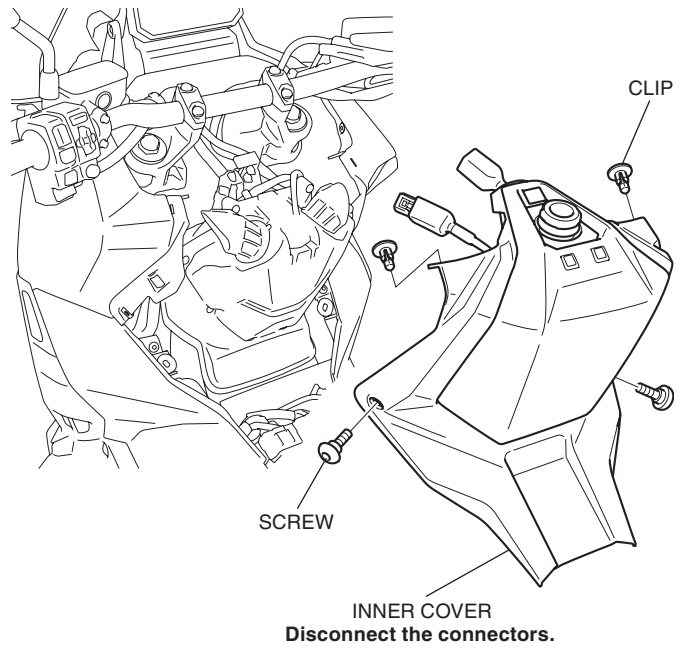

5. Remove the screws as shown.

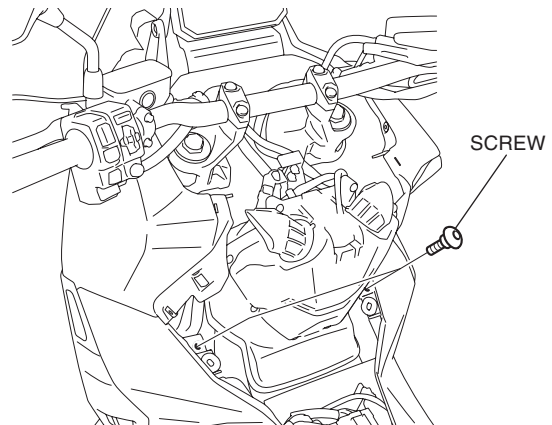

6. Remove the left inner upper panel and screw as shown.

- Repeat on the right side.

<Left side>

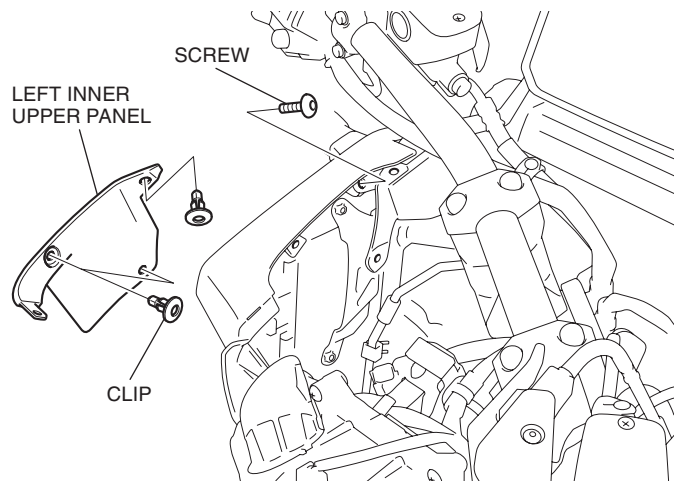

7. Remove the clips as shown.

<Left side>

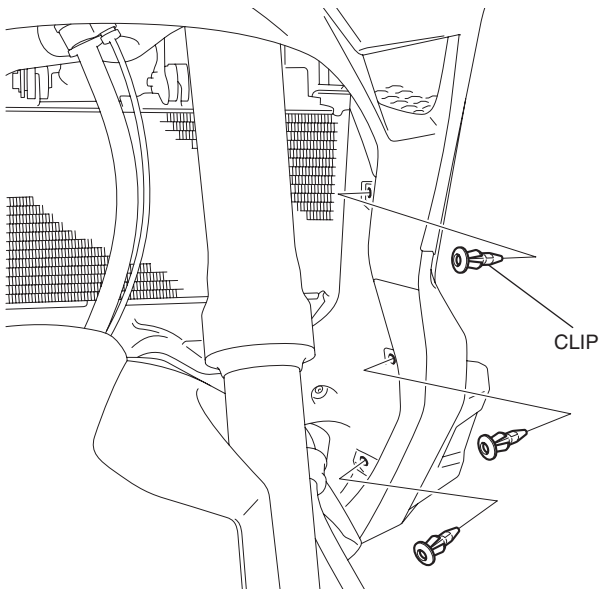

8. Remove the left side cowl as shown.

<Left side>

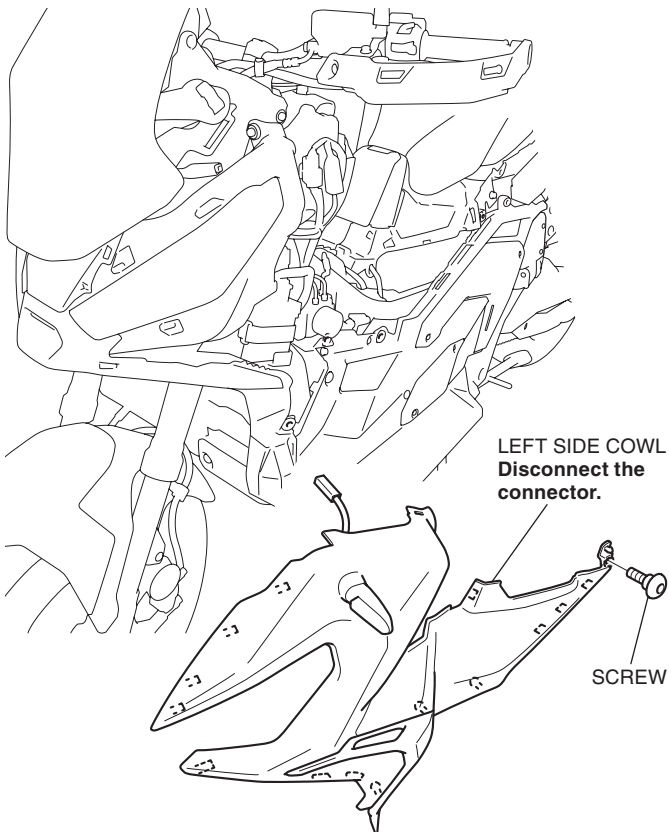

9. Remove the screw as shown.

- Repeat on the right side.

<Left side>

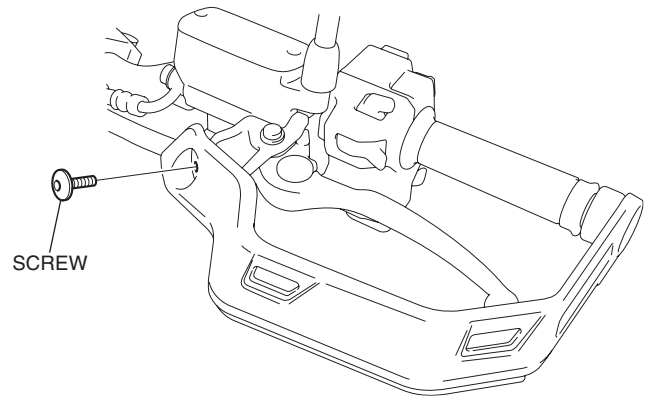

10. Remove the parts as shown.

- Repeat on the right side.

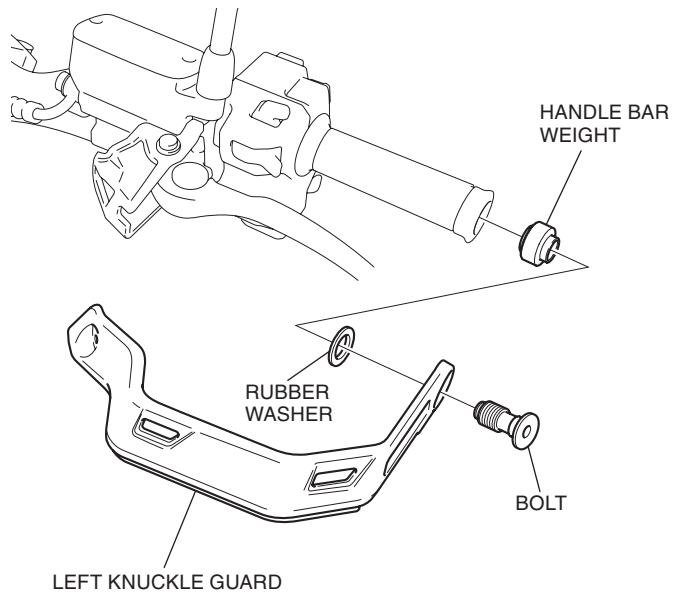

11. Remove the left grip as shown.

<Left side>

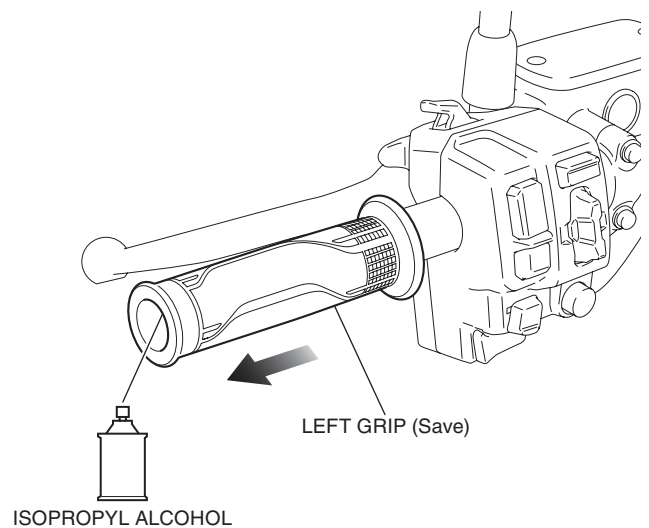

12. Using a isopropyl alcohol, remove all traces of adhesive from the left handlebar.

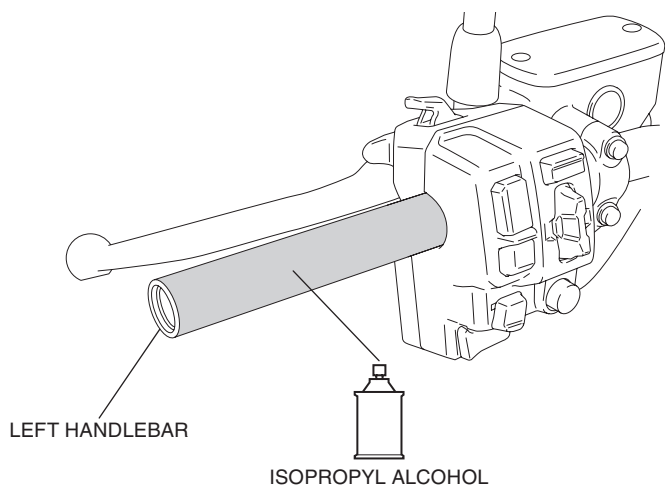

13. Loosen the bolts and move the lever bracket as shown.
<Left side>

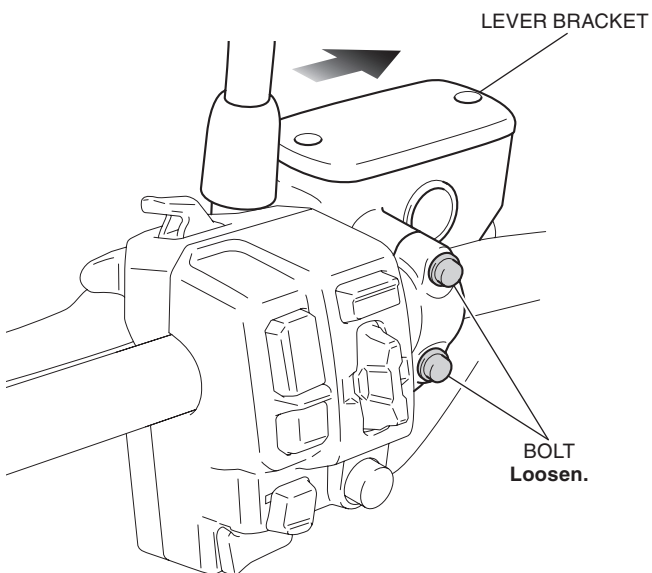

14. Remove the screws as shown.
<Left side>

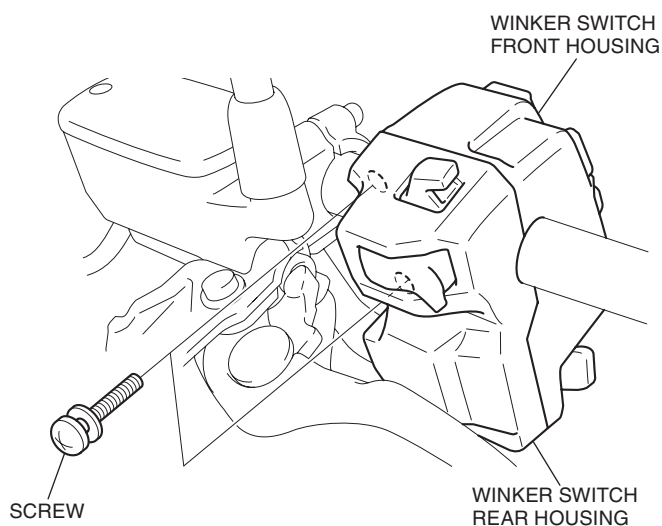

15. Liberally apply the Honda Bond A to the inside of the left grip heater from the kit as shown.

NOTE

Read the Instructions of the steps 15 through 18 carefully before operation and complete the installation quickly before the adhesive agent cures. Use an assistant to steady the motorcycle while installing the grips.

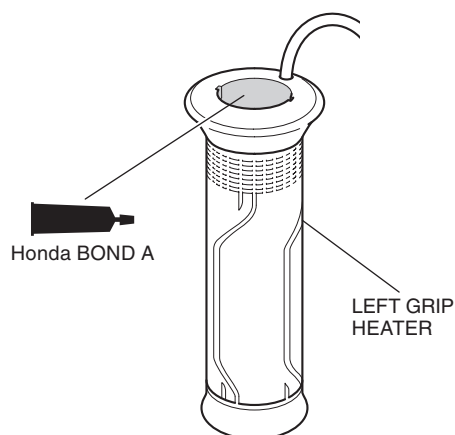

16. Apply the Honda Bond A to the left handlebar as shown.
• **Keep the winker switch rear housing while aligning it with the handlebar hole.**

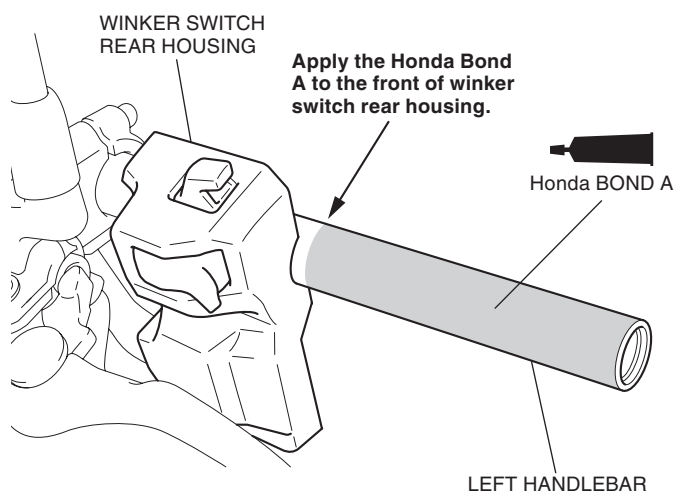

17. Spray isopropyl alcohol over the inside of the grip heater and outside of the left handlebar.

- This is done to ease alignment between the grip heater and the handlebar.

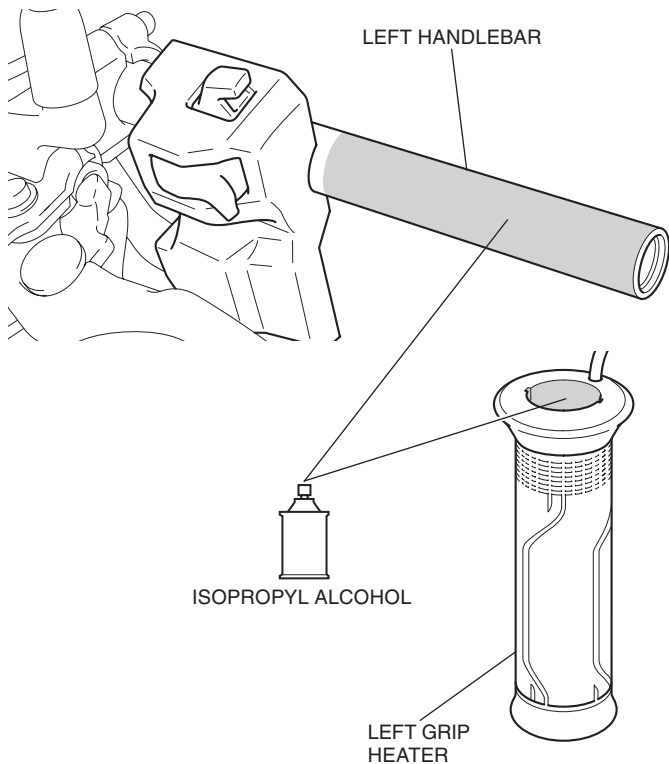

18. Slide the left grip heater onto the left handlebar as shown.

- Use an assistant to steady the motorcycle while installing the grips.
- Keep the winker switch rear housing while aligning it with the handlebar hole.
- Wipe up excess adhesive at once.

NOTICE

- Do not tap on the grip end with a hammer and do not twist the grip to install the grip heater onto the handlebar, as it can damage the element.

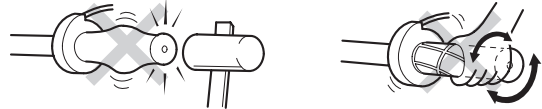

- Install so that there is no gap with the housing.

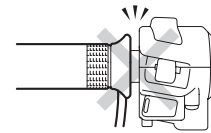

- If the grip gets stuck halfway during installation, apply isopropyl alcohol to the gap between the grip heater. Do not try to remove the grip heater using force or a screwdriver, etc. Damage to the grip heater wire can result.

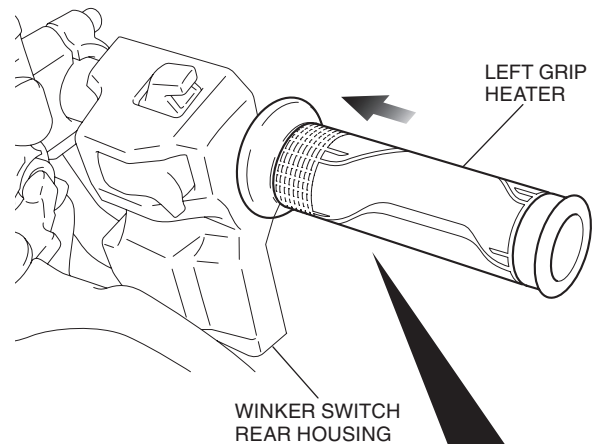

Insert until there is contact with the winker switch rear housing, then align the indicated position.

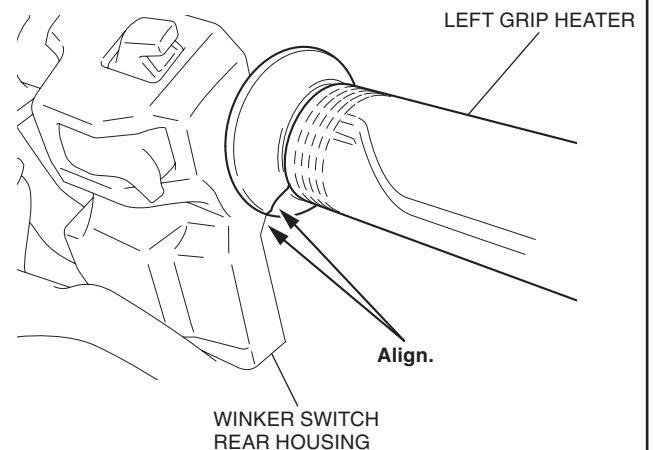

19. Route the left grip heater harness as shown.

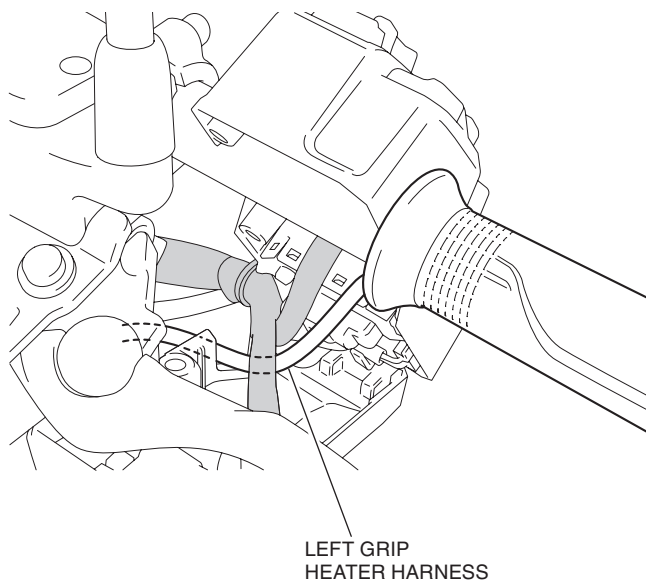

20. Install the winker switch front housing, winker switch rear housing and lever bracket in the reverse order of removal.

- **Confirm that any wire harness is not caught or too tight.**

21. Route the left grip heater harness as shown.

<Left side>

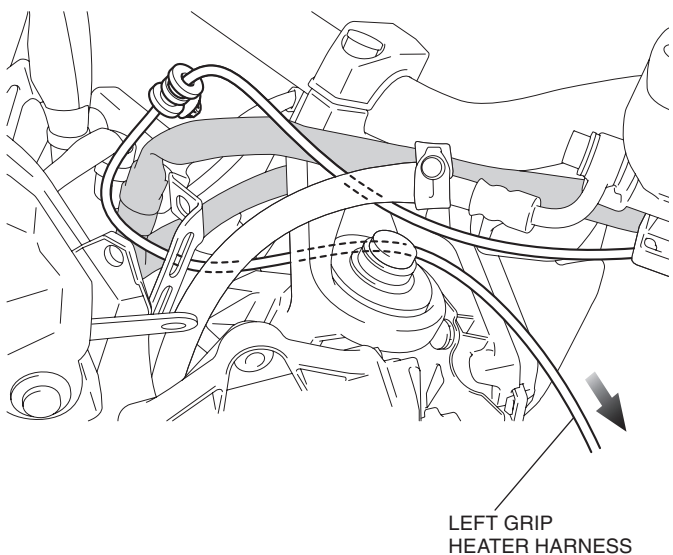

22. Secure the left grip heater harness as shown.

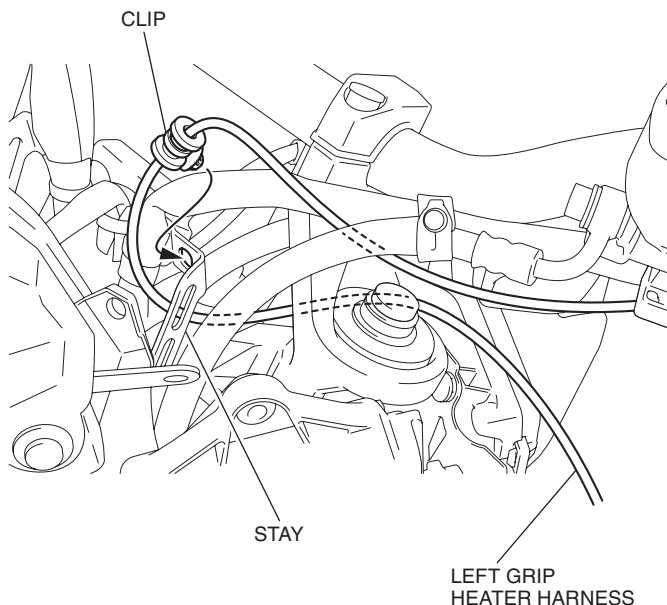

23. Secure the left grip heater harness with the band as shown.

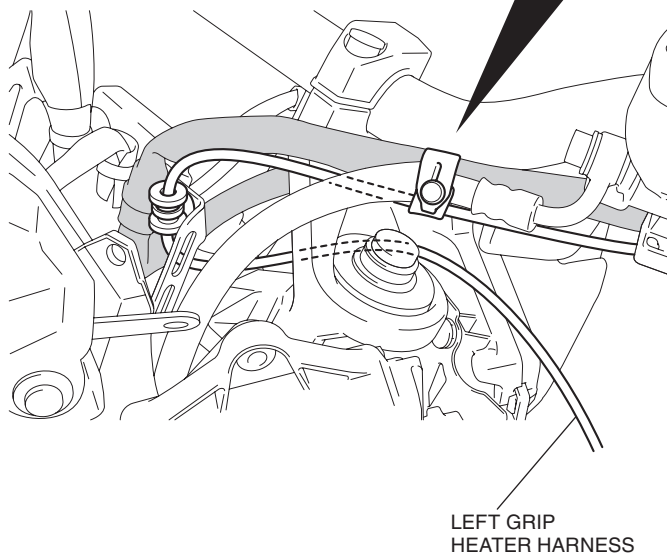
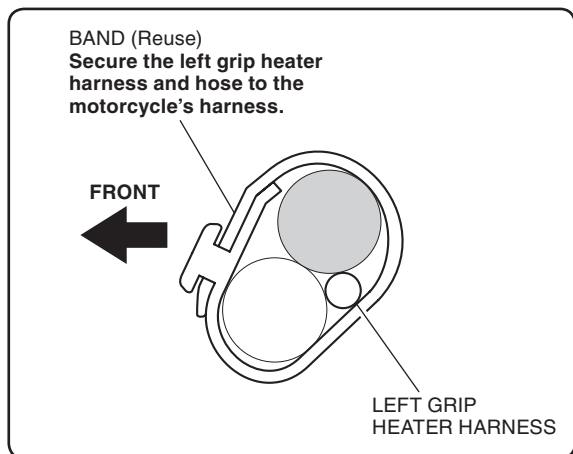

24. Secure the left grip heater harness with the wire tie as shown.

<Left side>

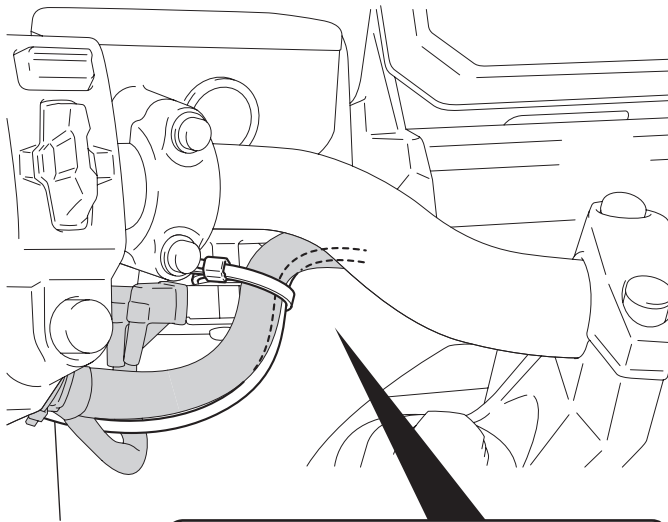

LEFT GRIP HEATER HARNESS

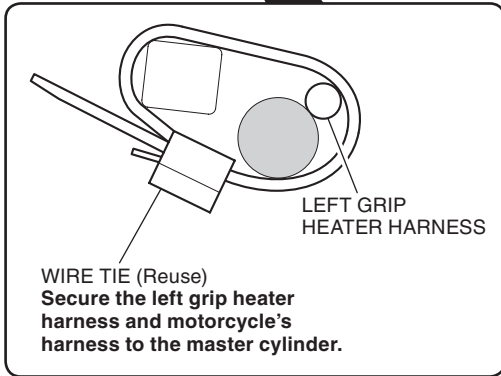

WIRE TIE (Reuse)
Secure the left grip heater harness and motorcycle's harness to the master cylinder.

25. Remove the stay, and route the left grip heater harness as shown.

<Left side>

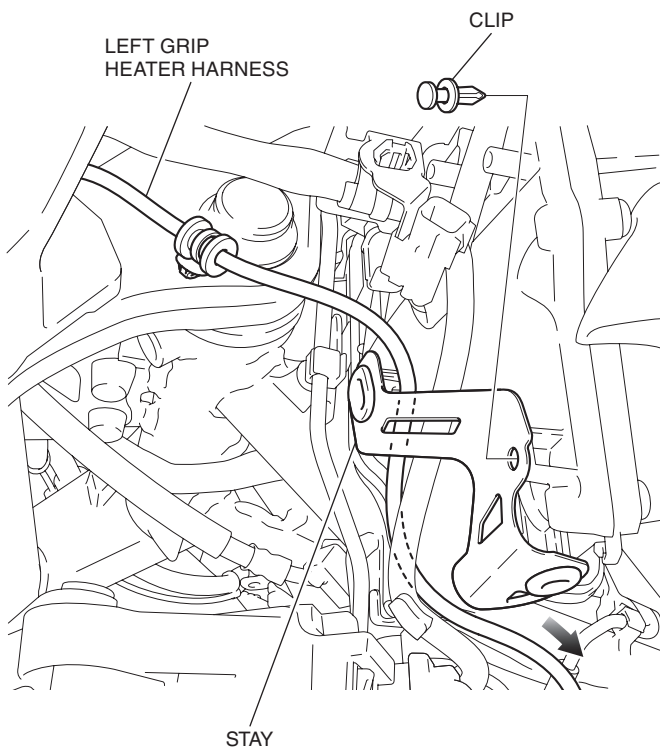

LEFT GRIP HEATER HARNESS

CLIP

STAY

26. Secure the left grip heater harness as shown.

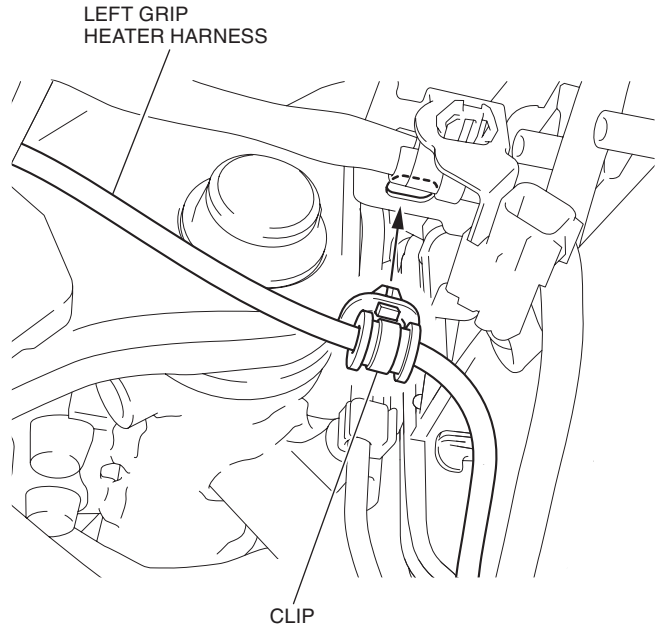

LEFT GRIP HEATER HARNESS

CLIP

27. Install the stay as shown.

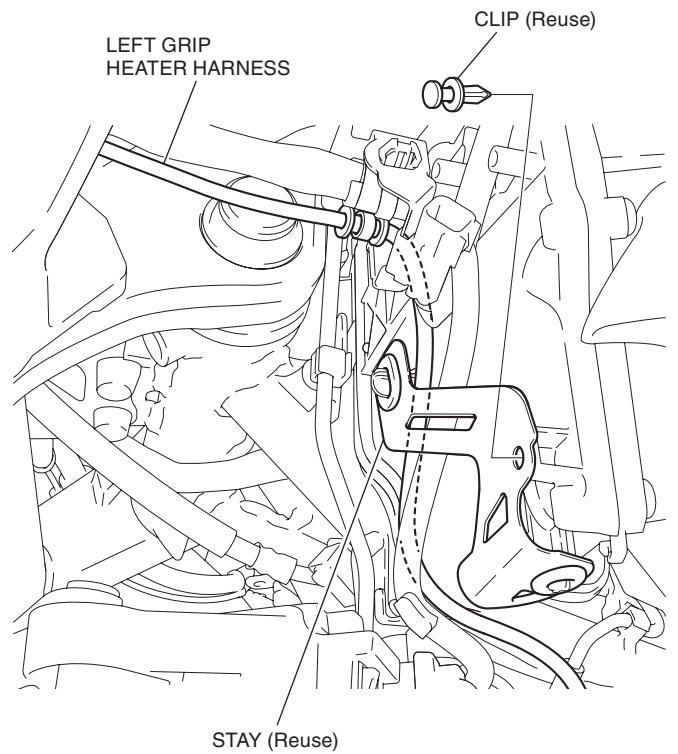

LEFT GRIP HEATER HARNESS

CLIP (Reuse)

STAY (Reuse)

28. Route the left grip heater harness as shown.
<Left side>

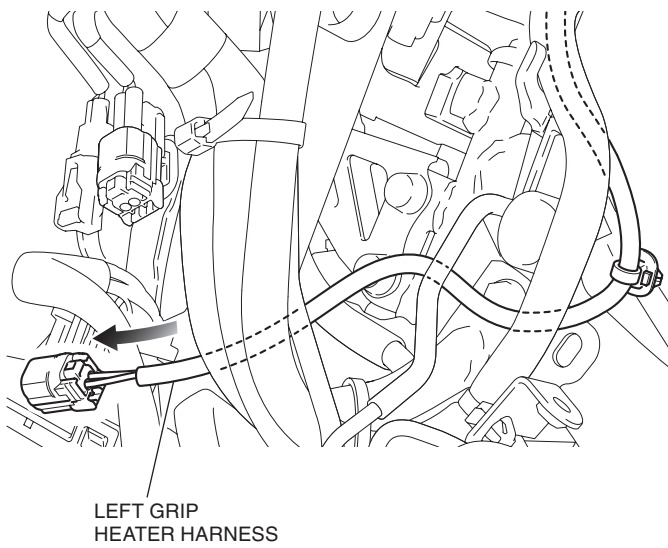

29. Remove the dummy connector as shown.

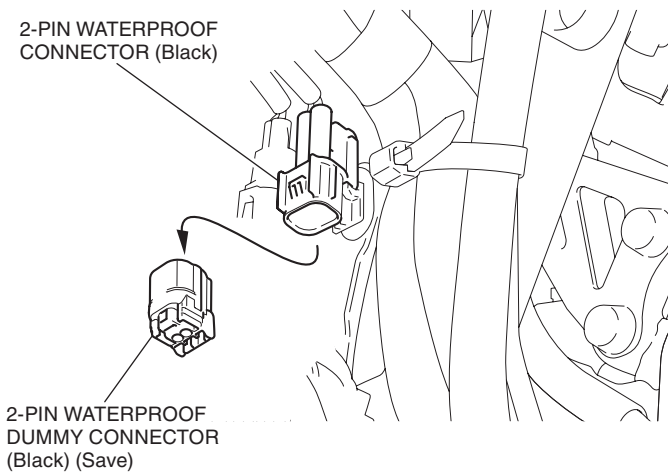

30. Connect the left grip heater harness as shown.

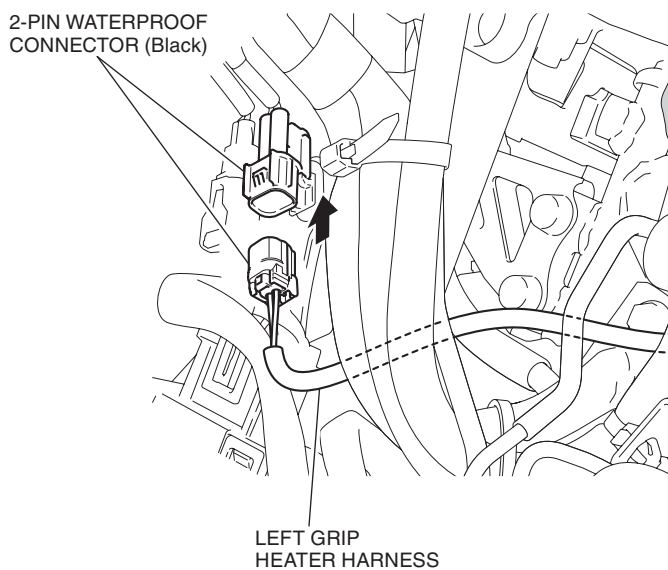

31. Secure the left grip heater harness as shown.

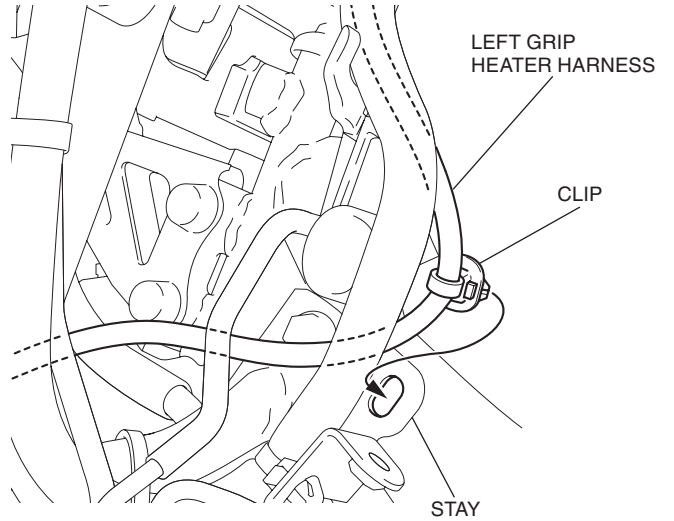

32. Secure the left grip heater harness with the wire tie as shown.

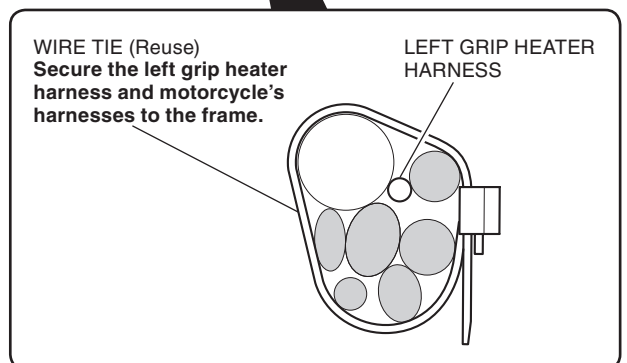
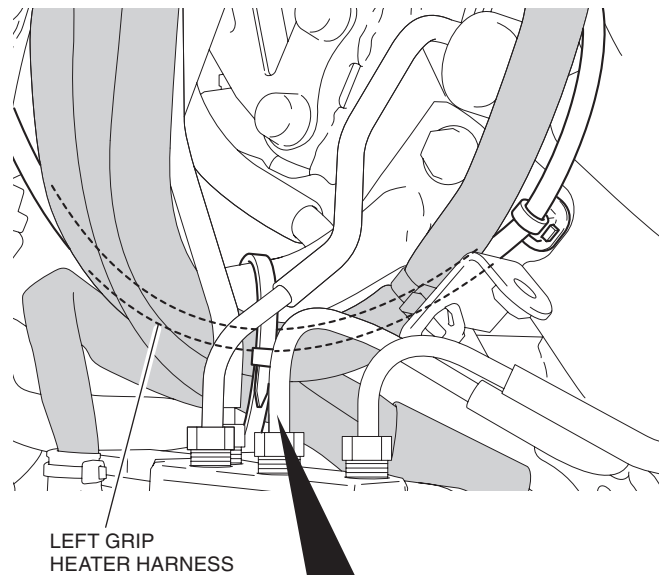

33. Loosen the bolts and move the brake master cylinder as shown.

<Right side>

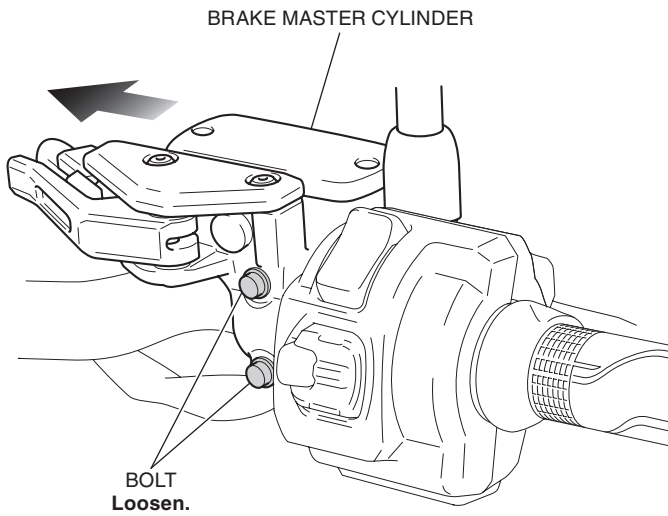

34. Remove the right rear housing as shown.

<Right side>

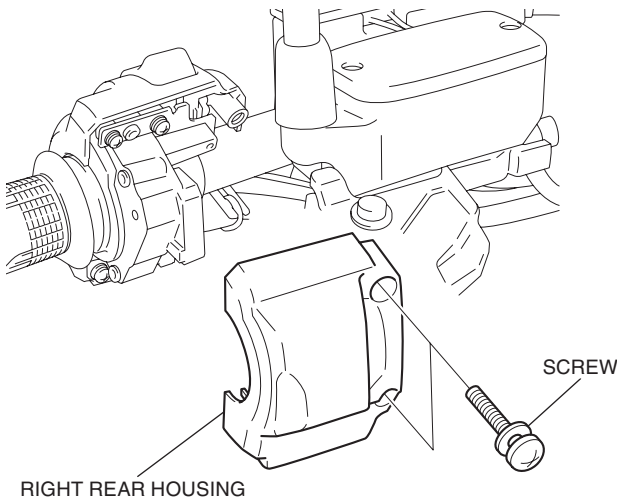

35. Remove the screws as shown.

RIGHT FRONT HOUSING

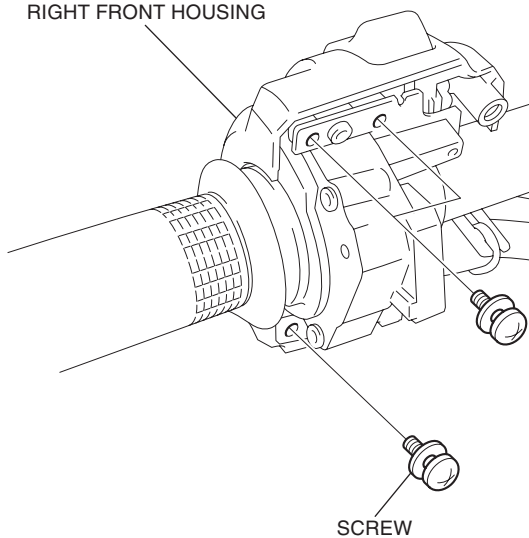

36. Remove the right grip as shown.

NOTE

Remove the right grip as instructed in the motorcycle's Service Manual.

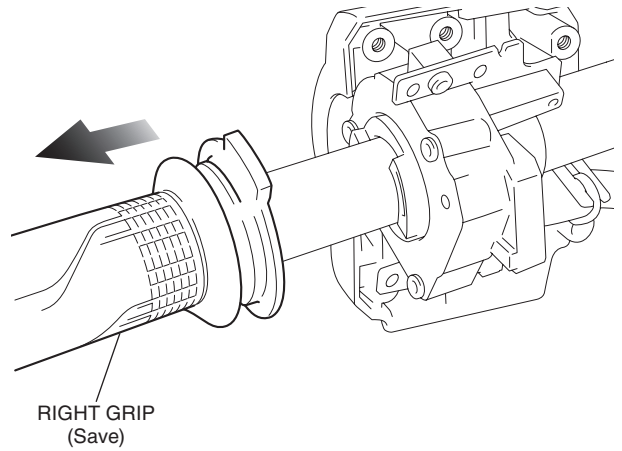

37. Apply grease to the hatched part as shown.

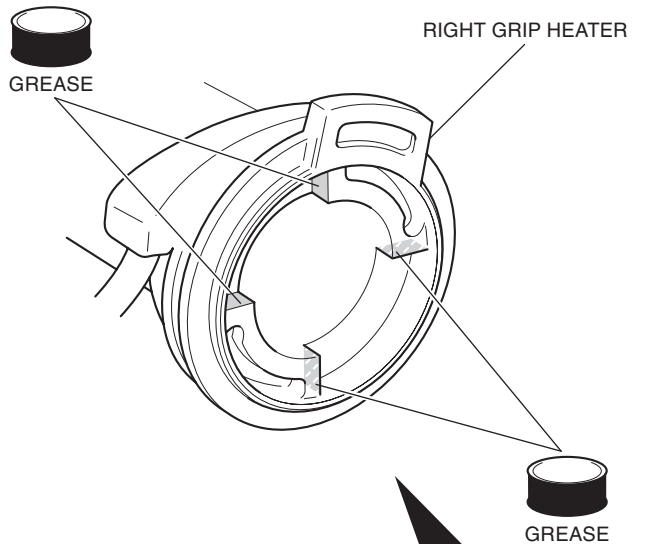

Be careful not to adhere grease to the outside of dimensions shown.

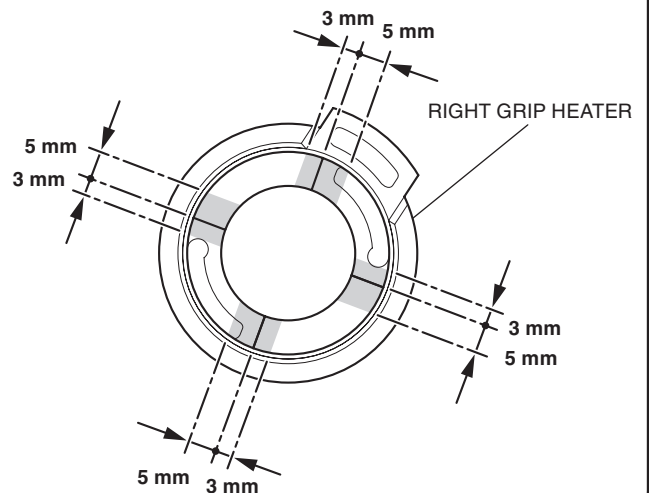

38. Apply grease to the hatched part as shown.

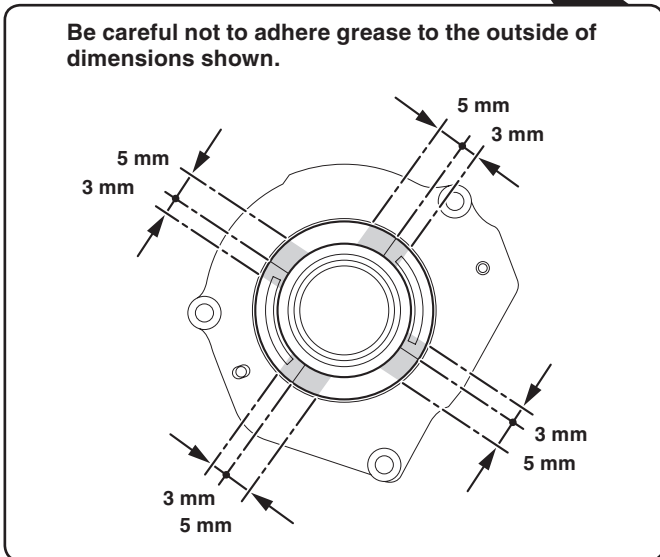
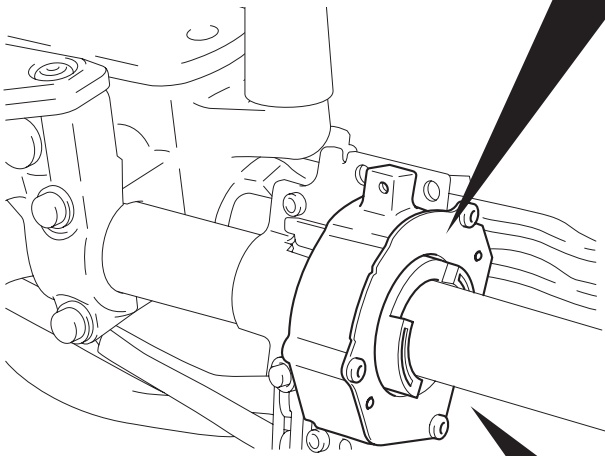
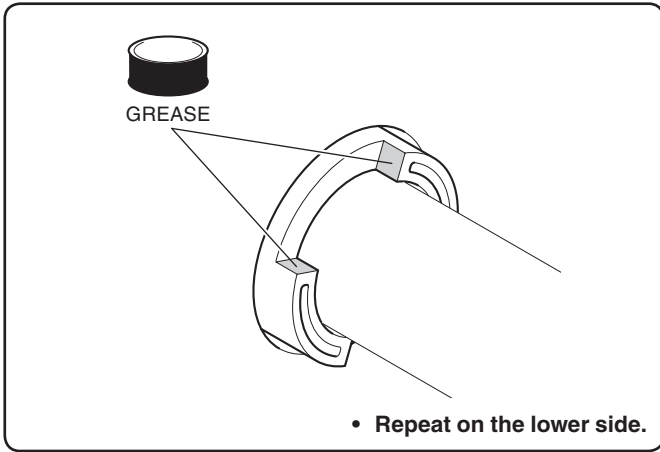

39. Install the right grip heater as shown.

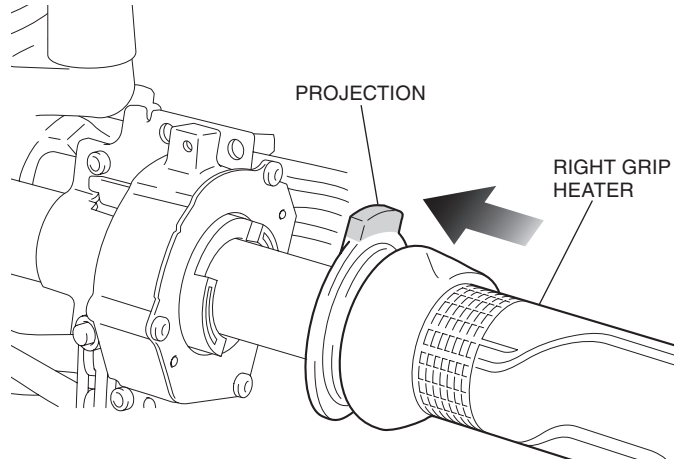

40. Install the right front housing, right rear housing and brake master cylinder in the reverse order of removal.

41. Twist the throttle grip as shown.

- Check for smooth opening of the throttle and that it automatically snaps closed from any opening, in all steering positions.

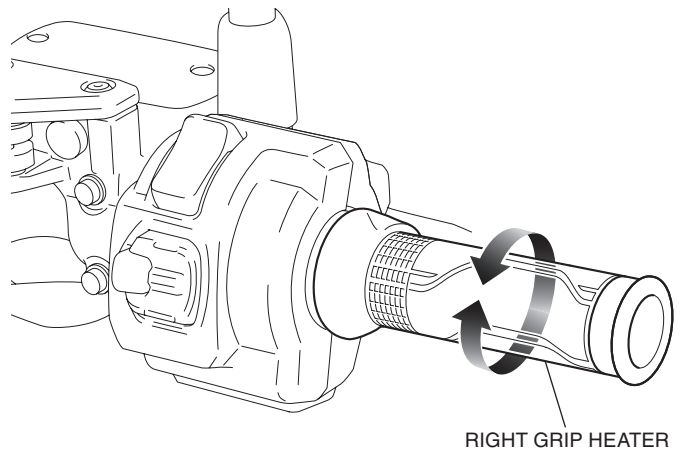

42. Remove the bolt as shown.

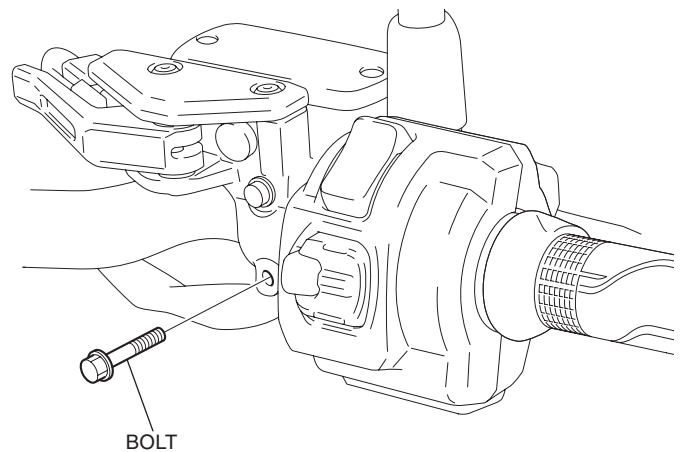

43. Install the clamp as shown.

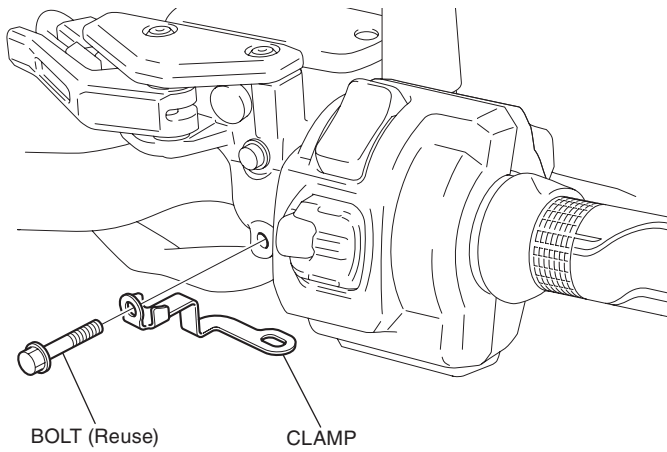

44. Secure the right grip heater harness as shown.

- **Open and close the throttle and confirm that there is no tightness of the grip heater harness.**

<Right side>

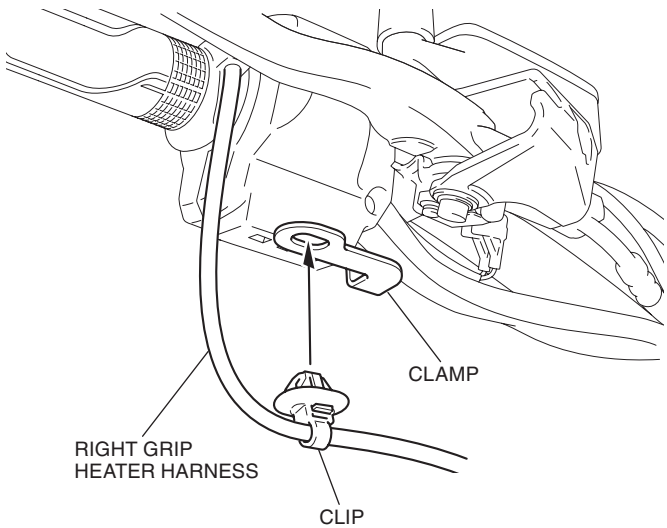

45. Route and secure the right grip heater harness as shown.

<Right side>

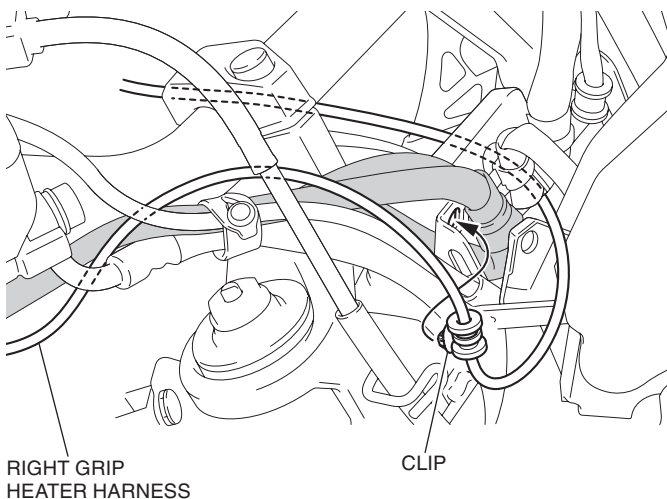

46. Secure the right grip heater harness with the rubber band as shown.

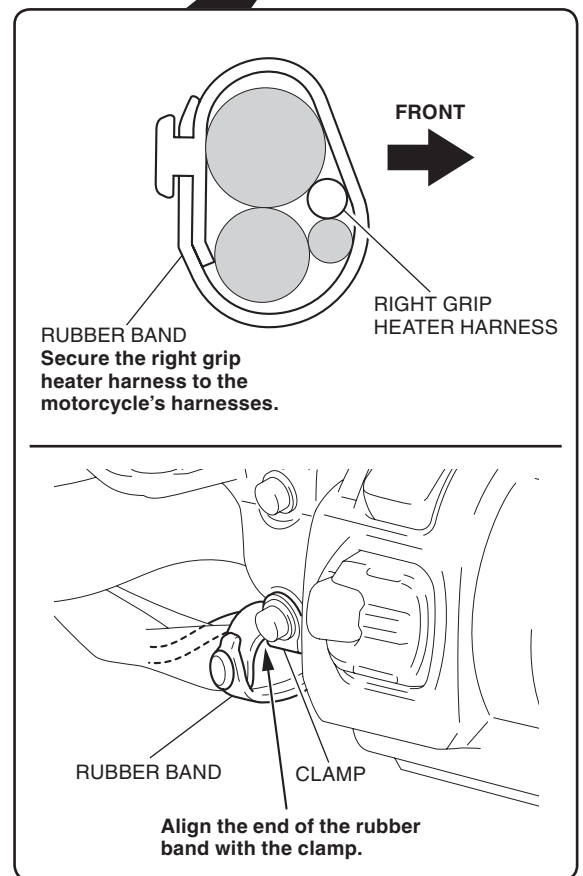
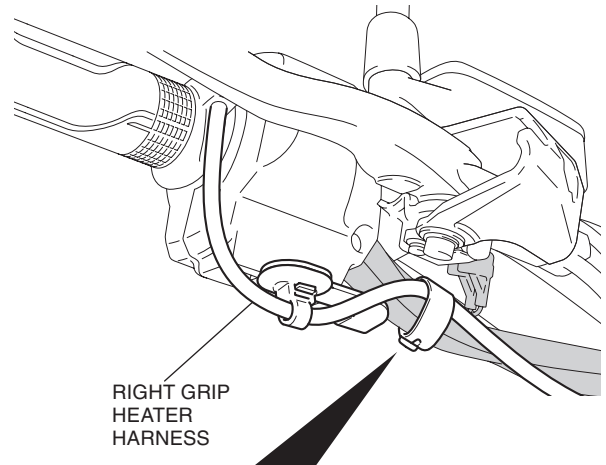

47. Secure the right grip heater harness with the band.

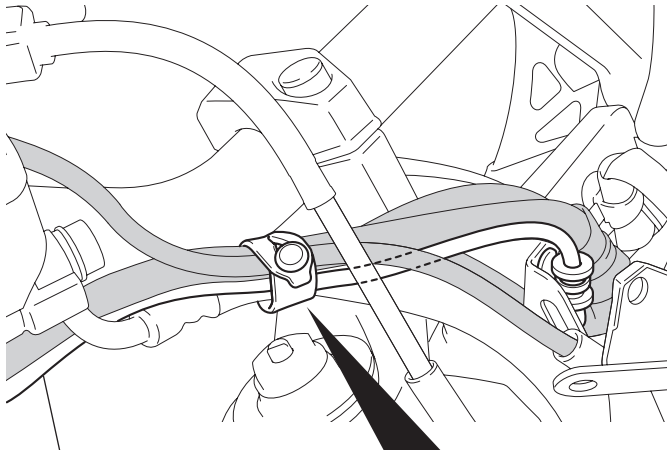

RIGHT GRIP HEATER HARNESS

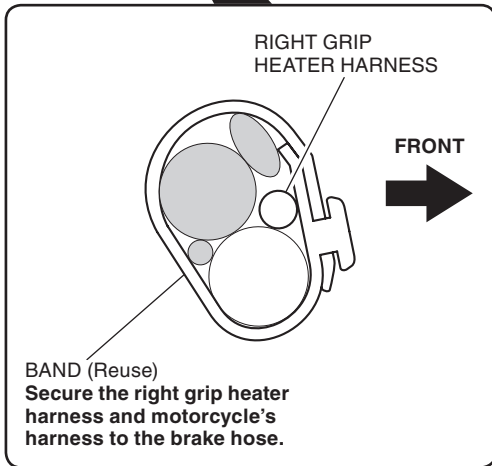

48. Remove the stay, and route the right grip heater harness as shown.

<Right side>

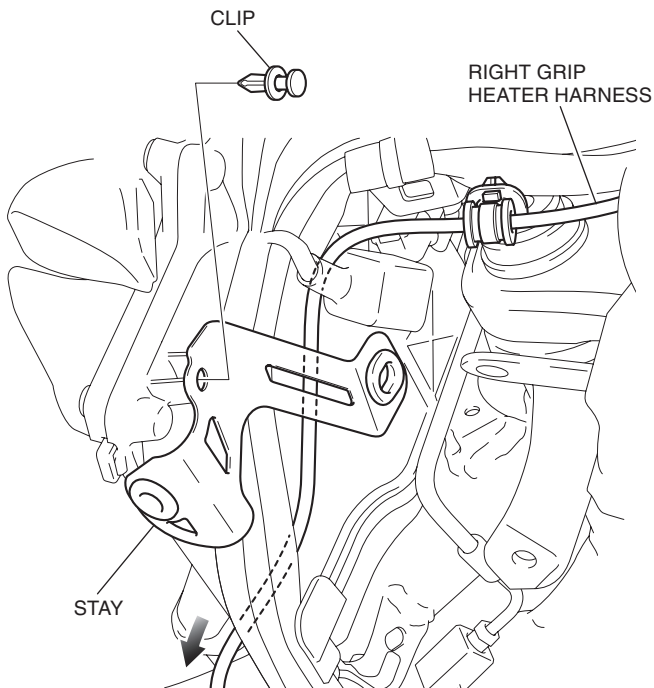

49. Secure the right grip heater harness as shown.

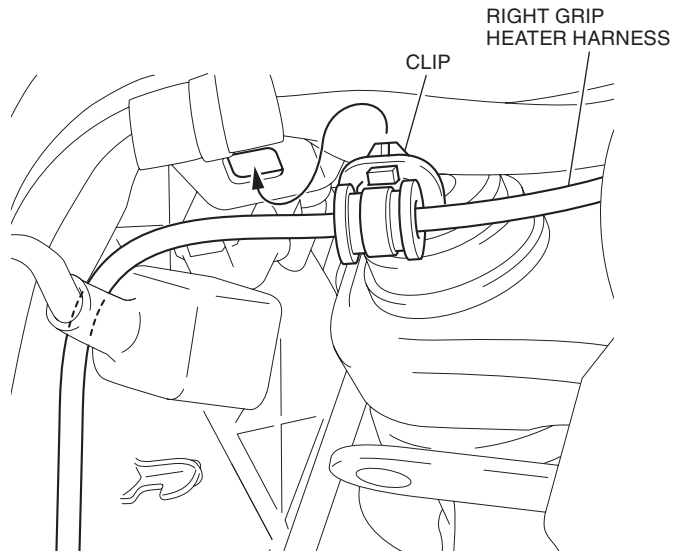

50. Install the stay as shown.

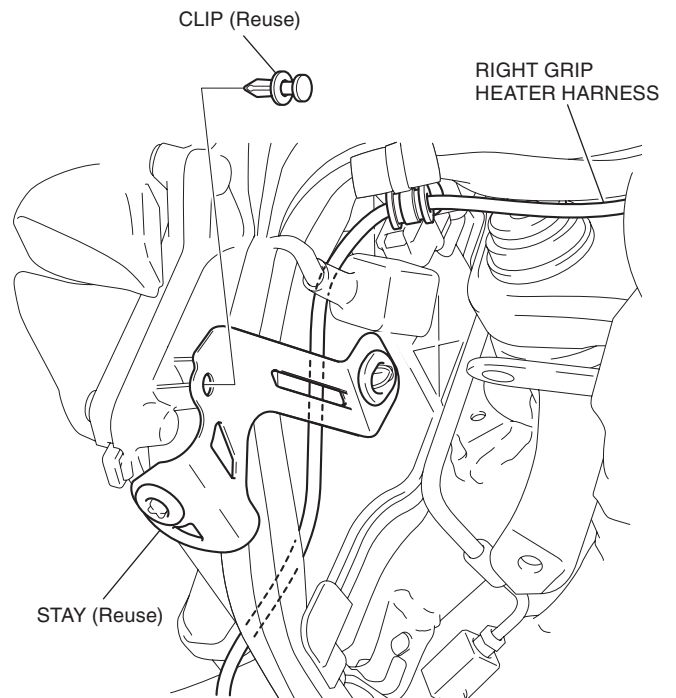

51. Remove the connector as shown.

<Right side>

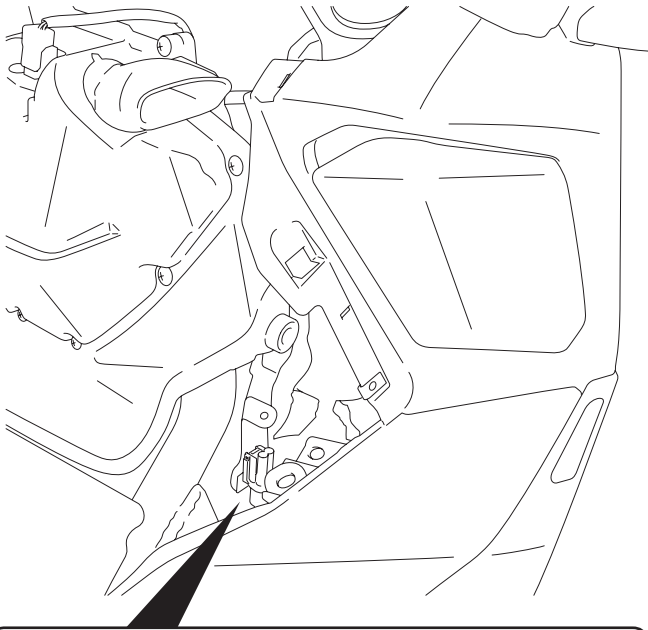

Remove the connector from the stay as shown.

2-PIN WATERPROOF
CONNECTOR (Black)

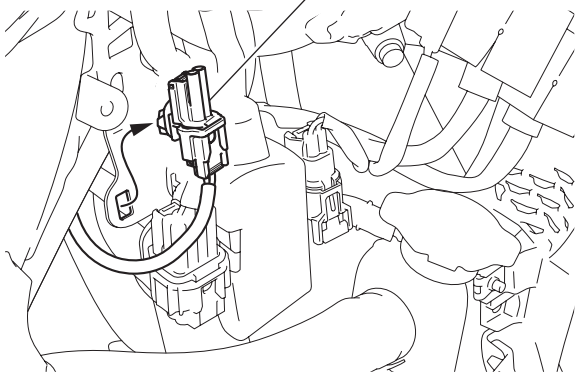

52. Remove the dummy connector as shown.

2-PIN WATERPROOF
DUMMY CONNECTOR
(Black) (Save)

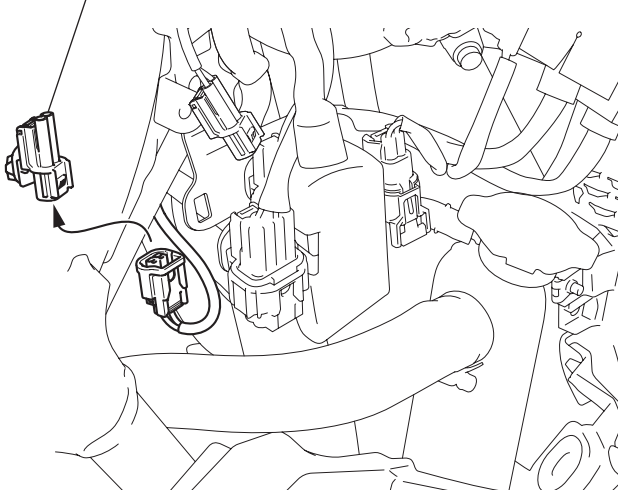

53. Connect the right grip heater harness as shown.

RIGHT GRIP
HEATER HARNESS

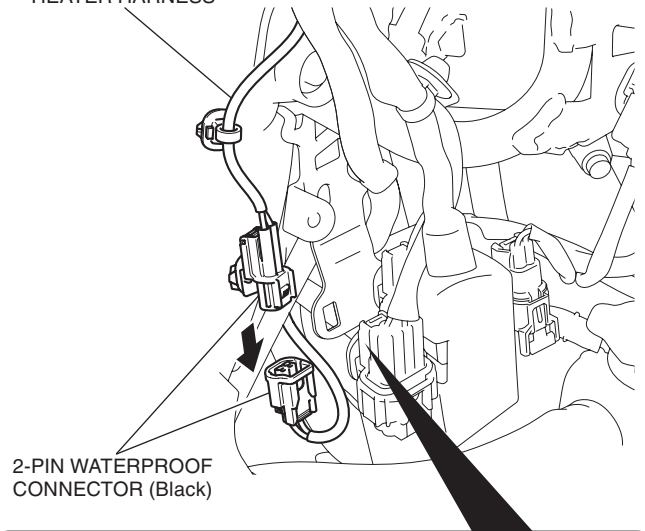

Secure the connected connector to the stay as shown.

2-PIN WATERPROOF
CONNECTOR (Black)

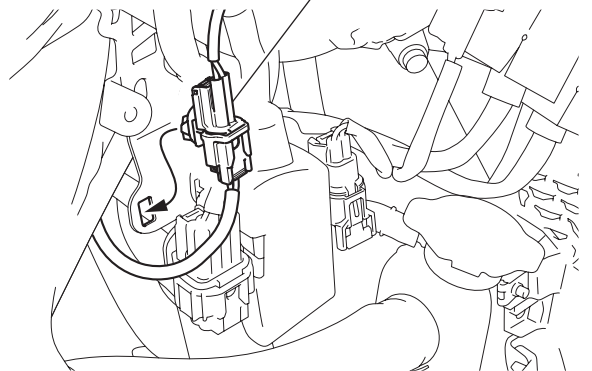

54. Secure the right grip heater harness as shown.

RIGHT GRIP
HEATER HARNESS

CLIP

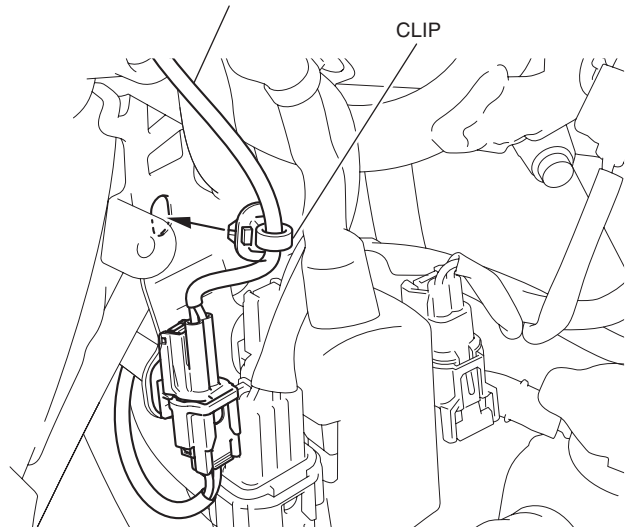

55. Check each harness for sufficient play.
- **Move the handlebar right and left and check that the harnesses are not pinched by neighboring components and that they are not pulled taut.**
56. Reinstall the parts as shown.
- **Clean up with isopropyl alcohol before applying thread lock.**
 - **Be sure to apply to the threads of the bolt.**
 - **Repeat on the right side.**

<Left side>

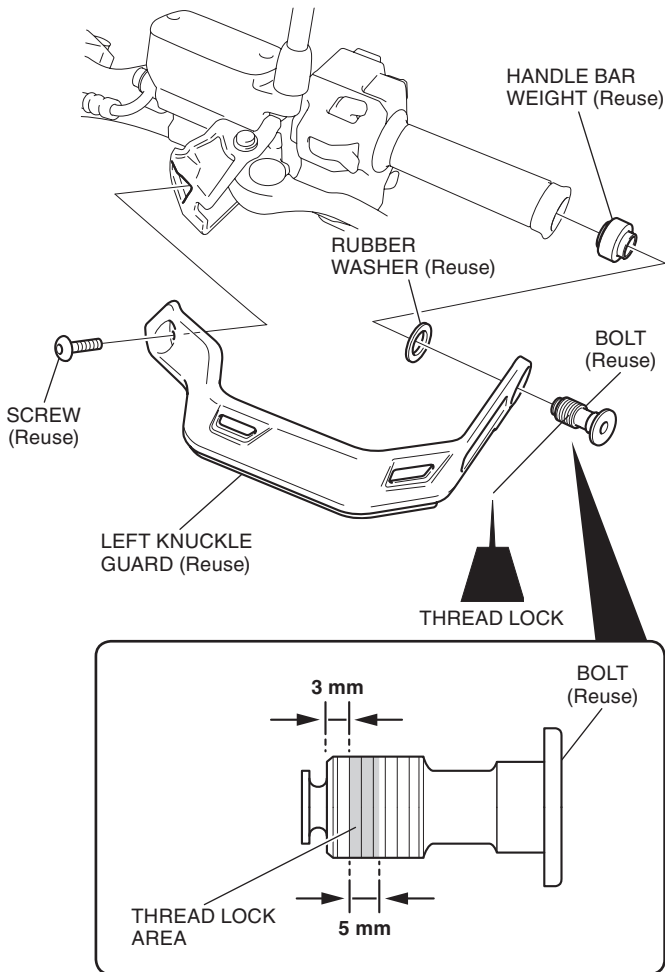

57. Install the motorcycle's parts in the reverse order of removal.
- **Confirm that any wire harness is not caught or too tight.**
 - **After installing the grip heater, perform the setting.**
58. Check the grip heater, throttle, headlight and the other lights for proper operation.

SETTING

1. Connect the SCS short connector (070MZ-0010300).
2. Turn the ignition switch ON.
3. Press and hold the Sel switch ► to display "SETTING".

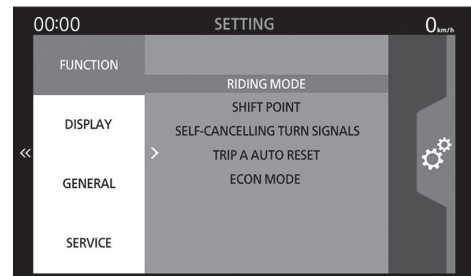
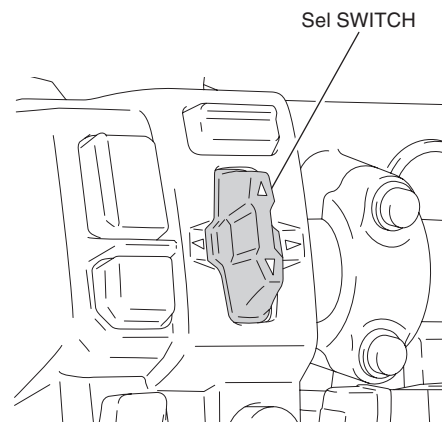

4. Select the "SERVICE", and then press the Sel switch ►.

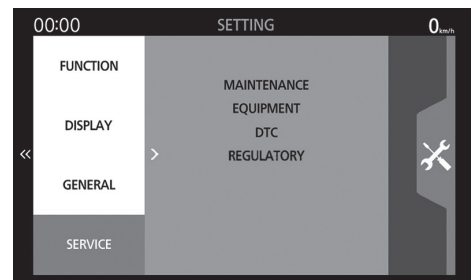

5. Select the "EQUIPMENT", and then press the Sel switch ►.

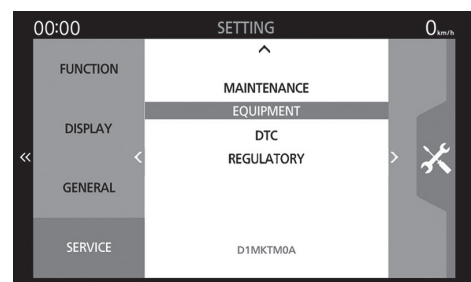

6. Select the “GRIP HEATER”, and then press the Sel switch ►.

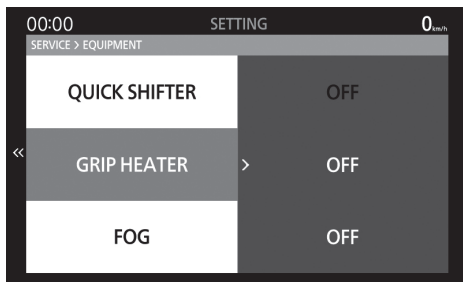

7. Press the Sel switch ▲ / ▼ to select “ON”.

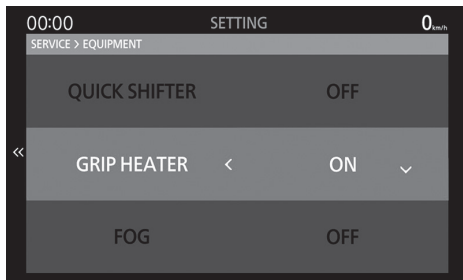

8. Press the Sel switch ◀, and then press and hold the Sel switch ◀ to return to the top screen.
9. Turn the ignition switch OFF and remove the SCS short connector.

SYSTEM DIAGRAM

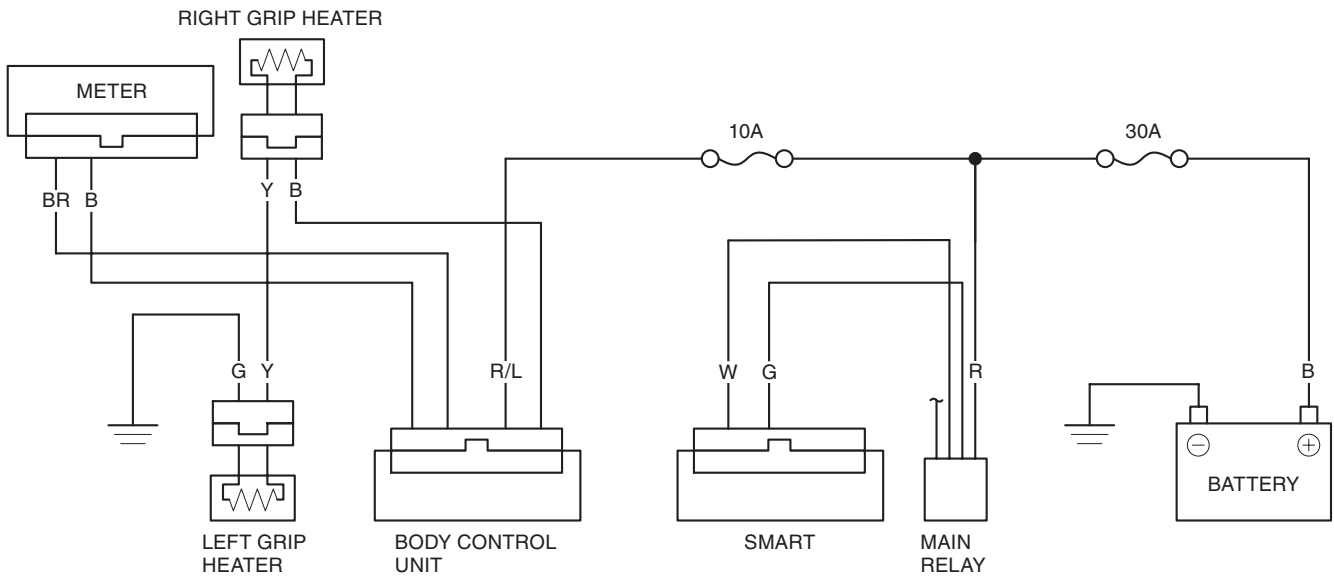

Identify wire colors :

B : Black
 L : Blue
 G : Green
 R : Red
 W : White
 Y : Yellow
 BR : Brown

DEALER TROUBLESHOOTING

- Stop the engine and turn the main switch OFF when you check the parts and circuits other than those of the grip heaters.

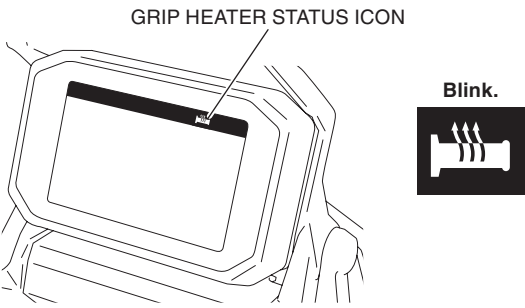
Symptom	Check
<p>Grip heater status icon blinks.</p> 	<p>If there is a malfunction, check the following.</p> <ol style="list-style-type: none"> Body control system DTC: <ul style="list-style-type: none"> Refer to the service manual for the motorcycle. Grip heater resistance: <p>Check for resistance between the terminals.</p> <p>➔ Standard:</p> <ul style="list-style-type: none"> Right : 1.9 ohms +/- 10% Left : 1.9 ohms +/- 10% <p>If the resistance is out of specification, replace the grip heater.</p> <p>The grip heaters and their circuits are OK, check the following.</p> <ol style="list-style-type: none"> METER / BCU <ul style="list-style-type: none"> Refer to the service manual for the motorcycle.